



BLOOD PRESSURE Fittings & Connectors

Nordson MEDICAL provides a complete line of Blood Pressure Fittings and connectors for use with noninvasive blood pressure (NIBP) monitoring equipment. Our Online Store offers blood pressure cuff connectors and monitor cable adapters for the bayonet (push to connect) and DINAMAP® (threaded) standards to fit tube sizes between 3/32" (2.4 mm) and 1/4" (6.4 mm).

BPF Series

BPF Series quick connects feature an ergonomic design for simple one-handed operation. Easy to connect and disconnect to existing tubing, many locations are replacing their metal bayonet connectors with these light weight connectors.

FEATURES & BENEFITS

- Works with BPM series bayonet connectors
- Female quick-connect fittings
- Works with compliant and noncompliant male connectors
- Ergonomic design for simple one-handed operation

SPECIFICATIONS

- **Materials:**
 - Acrylonitrile butadiene styrene (ABS) housing (black)
- **Fits Tubing ID:**
 - 3/32" (2.4 mm), 1/8" (3.2 mm), 5/32" (4.0 mm), 3/16" (4.8 mm)
- **Barb Style:**
 - 200 Series



BPF230-001

Bayonet-Style Female Quick Connect Fitting, 200 Series Barb, 1/8" (3.2 mm) ID Tubing, Black ABS Housing



BPF240-001

Bayonet-Style Female Quick Connect Fitting, 200 Series Barb, 5/32" (4.0 mm) ID Tubing, Black ABS Housing

BPL Series

The BPL Series incorporates a quarter-turn design that is commonly used in blood pressure applications – particularly in blood pressure cuffs. Strong tensile pull resistance, a resilient o-ring, and added thickness of the latch wall provide the connectors with a robust seal, ensuring a secure connection.

FEATURES & BENEFITS

- Alternative to luer connectors
- Ergonomic wing-grip design for ease of use and 360° of tubing rotation
- “Tube stop” design allows rotating barb to remain independent
- Quarter-turn design with audible and tactile click when latch is securely interconnected
- Compatible with industry connectors

SPECIFICATIONS

- **Materials:**
 - Fluid Path - Medical-grade ABS
 - Wing-Grip Shroud - Acetal
 - O-Ring - Buna-N
- **Sterilization:**
 - Can withstand bulk sterilization
- **Fits Tubing ID:**
 - 3/32" (2.4 mm), 1/8" (3.2 mm), 5/32" (4.0 mm), 3/16" (4.8 mm)
- **Barb Style:**
 - 200 Series

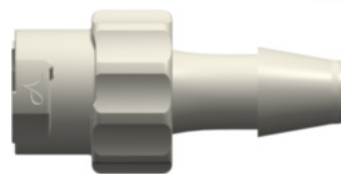

BPLF240-8012

Quarter-turn Female Blood Pressure Cuff Connector to 200 Series Barb, 5/32" (4.0 mm) Tubing ID, White ABS

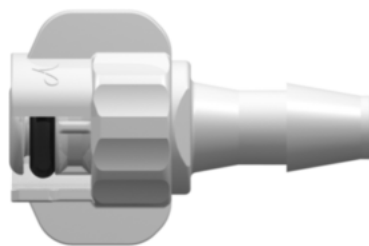

BPLM240-001

Quarter-turn Male Blood Pressure Cuff Connector to 200 Series Barb, 5/32" (4.0 mm) Tubing ID, White ABS; winged shroud, White Acetal, Buna-N O-Ring

BPM Series

The Nordson MEDICAL single-barb designs offer an excellent secure connection with better tensile pull results and hydrostatic burst testing results than traditional multi-barb designs, and the toughness of the DuPont Zytel® nylon is well proven.

FEATURES & BENEFITS

- Complies with ISO 80369-5 standard
- Male connectors fit singly or in pairs on blood pressure cuffs
- Male connectors compatible with both compliant and noncompliant bayonet-style female connectors on the market
- Single-barb design for secure connection and improved tensile and burst performance

SPECIFICATIONS

- **Materials:**
 - DuPont Zytel® nylon
- **Sterilization:**
 - Not available
- **Fits Tubing ID:**
 - 1/8" (3.2 mm), 5/32" (4.0 mm), 3/16" (4.8 mm)
- **Barb Style:**
 - 200 Series & 500 Series

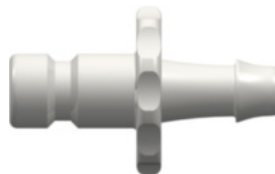

BPM013-1

Blood Pressure 80369-5 compliant Male Bayonet Connector to 500 Series Barb, 1/8" (3.2 mm) ID Tubing, White Nylon

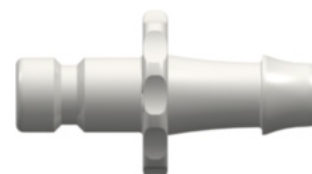

BPM025-1

Blood Pressure 80369-5 compliant Male Bayonet Connector to 500 Series Barb, 5/32" (4.0 mm) ID Tubing, White Nylon

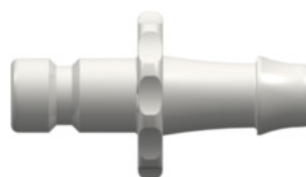

BPM240-1

Blood Pressure 80369-5 compliant Male Bayonet Connector to 200 Series Barb, 5/32" (4.0 mm) ID Tubing, White Nylon

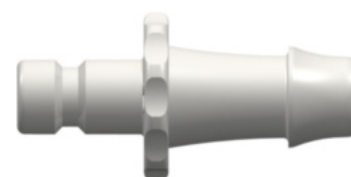

BPM035-1

Blood Pressure 80369-5 compliant Male Bayonet Connector to 500 Series Barb, 3/16" (4.8 mm) ID Tubing, White Nylon